



# Call to Artists: Request for Expressions of Interest and Qualifications Fire Station No. 2 Public Art Project

*updated August 13, 2024: Section 8. Artwork Type*



The District of Saanich's Fire Station No. 2 Redevelopment Project replaces an outdated building with a landmark expanded and enhanced fire station and training facility. As part of the project, the District is seeking Expressions of Interest and Qualifications from artists or artist teams to create permanent outdoor public art for the project.

**Deadline to apply:** August 28, 2024, at 4:00 p.m. PST

## 1. The Opportunity

The Corporation of the District of Saanich ("The District") invites Expressions of Interest and Qualifications ((EOI & RFQ) from professional artists or artist teams to create a permanent outdoor public artwork for the Fire Station No. 2 Redevelopment project ("FS2" or the "Project"). Through a two-stage public art jury process, an artist or artist team will be selected and commissioned to create site-specific integrated artwork.

## 2. Public Art Program and Process:

Saanich's civic public art program is guided by the [Comprehensive Arts Policy](#) (2002). Key goals for the program include:

- Increase liveability and attractiveness by making art an ongoing part of the public environment;
- Contribute to community placemaking through the integration of public art;
- Provide an opportunity for local and other artists and a mechanism for citizens to be involved in the design of their public environment;
- Increase public awareness and appreciation of the arts.



The Policy's Public Art Process ensures that:

- Any civic public art project will be chosen through an equitable process and that projects are of sufficient value to merit selection;
- Acquisition of artworks, and the selection and commissioning of artists and artist's proposals will be directed through a jury process.

### **3. Territorial Acknowledgement:**

The [District of Saanich](#) lies within the territories of the lək'wəŋən peoples represented today as Songhees and Esquimalt Nations, and the W̱SÁNEĆ peoples, represented today by the W̱JOŁEŁP (Tsartlip), BOKÉĆEN (Pauquachin), STÁUTW (Tsawout), W̱SIKEM (Tseycum) and MÁLEXEŁ (Malahat) Nations. The First Peoples have been here since time immemorial and their history in this area is long and rich.

The District of Saanich is proud that our name is derived from the W̱SÁNEĆ peoples. Saanich Council is committed to taking a leadership role in the process of healing wounds of the past and becoming a more just, fair and caring society.

### **4. Context:**

The District of Saanich is the largest municipality in the Capital Region, both in area and population. It is centrally situated, immediately north of Victoria and adjacent to Esquimalt, Highlands, Oak Bay, View Royal and Central Saanich. Saanich's recently updated [Official Community Plan](#), adopted by Council in May 2024, provides a physical and demographic overview in Sections 2.1 and 2.2.

An historical context of Saanich is provided in *Section 2.3:History* of the [Official Community Plan](#). Before colonial contact, the lək'wəŋən and W̱ SÁNEĆ peoples had their own territories and villages and travelled over these lands for purposes that included hunting, fishing and harvesting resources. See the Official Community Plan to learn more.

Starting in the 1860's, in the area known as Royal Oak where Fire Station No. 2 is located, early colonial settlers began altering surrounding forests and wetlands for farmland, timber and agriculture. A village established along West Saanich Road; some heritage structures preserved along this route reflect this early "village" and rural history. More information on the area may be found in the [Neighbourhood Timeline: Royal Oak](#), published by the Saanich Archives in 2023.

The Royal Oak community has grown significantly in past decades, with subdivision housing, regional amenities such as Saanich Commonwealth Place, shopping malls and a light industrial area. Recently it has been identified as one of Saanich's "centres," or primary growth areas, linking significant housing and commercial development opportunities and varied multi-modal transportation networks.

As the community developed, so too did the need to provide support services to the diverse and growing communities of Northern Saanich. Fire Station No. 2 was established in 1978, located in the heart of Royal Oak at the corner of Elk Lake Drive and Royal Oak Drive. The intersection has become an important connection point for vehicles, pedestrians, cyclists and transit.

### **5. Site Information:**

The redevelopment of Fire Station No. 2 in the Royal Oak neighbourhood replaces an outdated firehall with an expanded, improved and energy-efficient facility and training centre. Artwork installation is expected to coincide with the completion of the facility in Winter/Spring 2026.



The redeveloped firehall will better serve Saanich and its diverse community as it continues to grow and develop into the future. The new energy-efficient two-storey station will also be home to the District's fire training centre. The facility is designed to LEED gold, net zero carbon standards. It strives towards net zero energy while also maximizing the use of wood throughout (including mass timber structures), reducing power requirements through energy efficient design, functioning by electric-only power, and maximizing electricity generation through photo voltaic panels on the large roof. Externally the building is clad in durable brick and metal claddings that will require minimal maintenance.

The new building's apparatus bay now opens onto Royal Oak Drive for improved response times in emergencies and to better connect the community visually to the operations of the firehall. (Figure 1). The realignment of the station on the site has resulted in the creation of a small community plaza and renovated transit interchange adjacent to the station. It includes hard and soft landscaping for people waiting for a bus, pausing to rest, or passing by. (Figure 4).

## 6. Potential Artwork Locations:

In reviewing the site and considerations including public visibility, access and engagement, traffic flow, building design, maintenance and safety, the following locations have been identified:

- **Northwest (NW) Corner / Small Transit Plaza:** Integrated with the low wall separating the transit plaza from the Fire Station, immediately in front of the wall, or on the grounds on the other side of the wall. The grounds will be landscaped with multiple trees (existing and new plantings) and low vegetation. The low wall will also serve as additional transit and pedestrian seating. (Locations Map: Figure 2: A & B; Renderings: Figures 3 and 4)
- **Adjacent to Front Entrance Sidewalk:** Area closest to the street (Elk Lake Drive) on North side of sidewalk, integrated into the low wall or inside the wall within the grounds. (Locations Map: Figure 2; Rendering: Figure 5)
- **Brick "Fin Walls"** on NW elevation along Royal Oak Drive (Locations Map: Figure 2: D; Rendering: Figure 6) and possibly on NE elevation (Locations Map: Figure 2: E; Rendering: Figure 7). Artwork could be affixed or in front of walls (considering maximum public visibility with existing and new trees and transit shelters).

The final location/s of the artwork will be determined by the project team and selected artist.

## 7. Potential Themes or Artwork Considerations:

While no single, specific theme has been identified for the project, some potential elements to consider for the art opportunity include:

- **Community First: Saanich Fire and First Responders**  
Saanich Fire plays a vital role in the community. Its First Responders are on site 24/7, responding to increasing calls for support each year. The mission, vision and goals of [Saanich Fire](#) include to preserve and protect life, property and the environment and to support the needs of our growing and diverse community. This aligns with the District's motto "serving the people" and its [mission, vision and values](#), as we strive to live in harmony with each other and the environment, both urban and rural. How can the public art project express the guiding principles of Saanich Fire and its role in the community?
- **Making Connections: Trails and Transitions**  
Saanich's Royal Oak area has long been a place of crossroads and transitions -- between hunting and gathering areas and village sites, rural communities and urban



centres, natural areas and built environments. Whether by trails, early stagecoach, trains, roadways or more recent modes of rapid transit or active transportation, Fire Station No. 2's public art project offers pathways for connecting, community-building, learning and discovering ways forward together. How could the art project reflect this?

- **Caring for the Land, the People, and the Future**

lək 'wəŋən and W̱ SÁNEĆ peoples have faced great losses and hardships through colonization. The District of Saanich and Saanich Fire are committed to learning and reflecting on the community's colonial past as part of Saanich's path towards reconciliation, recognizing First Nations heritage, and seeking opportunities to build positive, respectful relationships with local First Nations and Urban Indigenous communities. Through values of respect, caring for the environment and the community, we strive to improve Saanich for everyone and all things, including future generations. Can this public art project provide an opportunity to share knowledge and culture, help build understanding and relationships, and support the journey towards reconciliation?

- **Environment for Change**

The environmental goals and incorporated natural elements of Fire Station No. 2's redevelopment provide opportunities to reflect on climate change and its impacts on our region, and champion environmental and climate stewardship. The Fire Service, as lead responders to the impacts of a changing climate on our community, face fires as well as floods, extreme heat, storms and other natural and human-led emergencies. How can the public art opportunity inspire awareness, appreciation and actions that we collectively need to take?

## 8. Artwork Type and Considerations

The project seeks permanent exterior artwork that is durable, long-lasting, safe and low maintenance. It may be functional but is not required. Artwork should be suitable for the public site in scale, content, execution, materials and quality. Due to their more temporary nature and maintenance requirements as well as the building's design, murals are not being considered for this project. As the site is located at a busy intersection and transit hub with commuter, pedestrian and multi-modal traffic, the setting is not appropriate for moving digital, video or sound-integrated artwork.

## 9. Budget:

The available budget for artist fees and expenses related to this project is **\$190,000 CAD plus GST**. No further compensation will be made to the artist for costs associated with this project. This fee is inclusive of but not limited to: artist fees (including design and consultation), insurance, administration and travel, engineering, technical, and professional services fees (if applicable), permit fees (if required), materials, fabrication, site preparation (in coordination with Saanich), transportation and delivery, installation, maintenance plan development, project documentation, attendance at unveiling, artist contingency and other incidental expenses. See "Other Requirements" for more information.

## 10. Artist Eligibility

This Artist Call is open to [professional artists](#)\* or artist teams who are either residents of British Columbia, or from British Columbia, with ongoing connections to the province. Artists must be residents of Canada and legally able to work within Canada. First Nations and Indigenous artists, as well as artists who identify with equity-deserving groups are encouraged to apply.



\*“Professional artist” as per the [Canada Council for the Arts](#)’ definition. Qualified artists for this call will have demonstrated professional experience in public art as well as technical and organizational capacity to successfully design, plan, coordinate, fabricate, execute and install large-scale permanent public artwork. Qualified artists will have experience working collaboratively with staff and project teams.

**Accessibility:** Artists with accessibility needs who require assistance with submitting their application or accommodations through the process are invited to contact staff.

## 11. Selection Process

Artwork will be chosen through an established public process. The Public Art Jury (“The Jury”) is comprised of artists, community representatives, a project team member and a staff department representative.

The selection process will follow a two-stage juried competition:

### Stage 1: Artist Call for Expressions of Interest and Qualifications (EOI & RFQ)

Artists or artist teams submit an application expressing their interest in the project and demonstrating their professional qualifications and experience. See Section 12: *How to Apply* for more information.

The Jury will review all submissions meeting eligibility requirements and identify a shortlist of up to five (5) artists to proceed to Stage 2: Request for Proposals. The Jury will review and assess submissions considering project goals and objectives and selection criteria that include:

- artistic merit of past work
- professional experience and proven ability to produce successful public art projects
- demonstrated interest and capacity to create original and engaging public artwork that would respond to the project’s design, context, and theme/s.

### Stage 2: Request for Proposals (from Shortlisted Artists Only)

Shortlisted artists will be notified and invited to prepare a detailed artist proposal for review. A Terms of Reference document will be provided to assist short-listed artists prepare their proposals. Shortlisted artists will be asked at this stage to provide two (2) professional references from past projects (including name, title, business/organization, contact information and related project).

Stage 2 proposals will be reviewed for feasibility. Artists will meet with the Jury to present and discuss their proposals (online options available). Presentations will be arranged for November 2024 (date to be confirmed). Finalists completing Stage 2 will receive **\$1900 CAD + GST** (one per team).

The Jury evaluates completed submissions and presentations based on established criteria and selects the successful proposal. Considerations would include:

- Artistic merit;
- Suitability of the proposal for the context, parameters and themes of the project;
- Quality and practicality;
- Appropriateness to the chosen site;
- Previous experience and qualifications including the ability to complete public art projects successfully, working in collaboration with staff and project teams;
- Feasibility, durability, maintenance, and public safety.

The District and Jury reserve the right to choose no proposal if none are determined to merit selection.

## 12. Estimated Project Timeline \*

August 7, 2024	Online Information Session: Register <a href="#">here</a>
<b>August 28, 2024 4:00 p.m. PST</b>	<b>Submission Deadline for Stage 1 Call to Artists</b>
September 1–10, 2024	Public Art Jury review of applications and shortlist of artists to proceed to Stage 2: Request for Proposals
September 10–15, 2024	Artist notifications. Terms of Reference to shortlisted artists
<b>November 5, 2024 4:00 p.m. PST</b>	<b>Submission Deadline for Stage 2 Artist Proposals</b>
November 5–30, 2024	Technical Review of Stage 2 Proposals Proposals reviewed by Jury and artist presentations to Jury (date to be confirmed).
By November 30, 2024	Jury Selection of artist for project; artists notified.
December 2024	Artist Agreement completed and project begins
January–December, 2025	Final design development, technical review and approvals Artwork fabrication and construction
January–May, 2026	Artwork installation (timeline to be confirmed)
May–July, 2026	Artwork Unveiling at Fire Station Official Opening (TBA)
2026 (post unveiling)	Project Wrap-up, Documentation, Maintenance Plan

\* Selected artist must be able to meet the project’s anticipated timeline.

\* Schedule subject to change by The District of Saanich.

## 13. How to Apply

To apply, artists submit an [online application form](#) and attach required documents that include:

- **Applicant Information** – Complete in full. List a primary contact for artist teams and the names of all team members where prompted.
- **Letter of Interest** – (maximum 2 pages) Describe your interest in this project and why your art practice, relevant experience and ability make you well-suited for this project. Highlight your qualifications and experience working on projects of similar scale. Building from your past experience, your artistic process and approach, how you would intend to approach this opportunity? An artwork proposal is not required in Stage 1.
- **Brief Artists’ Biography** – up to 75 words. For teams, submit a single document with a brief bio for each artist team member (75 words per team member).
- **Artist Resume/C.V.** – (one per artist for teams, maximum 4 pages per C.V.) – Include a list of recently completed projects and your role.

- 
- **Digital Images of Work** – Submit up to ten (10) high-resolution images of your artwork (including recent examples). File names must include, in order, last name, first name, image number and match your Digital Images List. Artist teams submit up to 10 images.
  - **Digital Images List** – In a single document, provide the following documentation information for each artwork (50 words per image), in this order: date, title, location, commissioning entity, budget, approximate dimensions, materials, brief description, your role (solo, lead, team).

All document and image files provided must include your last name and first name.

Carefully review these instructions and the online application form in full before proceeding to apply. Ensure that your submission content is prepared, saved, and ready to submit when you complete the online application form, as you cannot save your information and return later.

Incomplete applications will not be considered.

### **Online Information Session:**

Interested artists are invited to participate in an online information session scheduled for **August 7, 2024**. Register online at: [Register for Online Information Session](#).

### **Questions:**

For questions, or if you require assistance preparing your application, please contact:

Brenda Weatherston  
Public Art Coordinator and Programmer, Community Arts and Public Art  
Community Services Division, Parks Recreation and Community Services Department  
e. [brenda.weatherston@saanich.ca](mailto:brenda.weatherston@saanich.ca)  
t. 250-475-5557

**Note:** All communications (verbal and written) regarding the public art competition are to be directed to the Public Art Coordinator. Artists may not contact Jury members to ask questions or discuss the project, their proposals, or the jury process. Failure to adhere to this requirement may result in disqualification from the competition.

### **Confidentiality:**

The collection of personal information for this competition is authorized under the Local Government Act, Community Charter and section 26(c) of the Freedom of Information and Protection of Privacy Act. The information will be used to communicate information to Staff and the Project Jury for the purpose of evaluation and selection. Materials submitted for consideration to public art competition will be treated as confidential. Ideas presented are understood to be the intellectual property of the applicant and the information contained therein will not be reproduced or adapted for any purpose, except to the extent necessary as described above. The District will not release this information to the public except as required under the Province of BC's Freedom of Information and Protection of Privacy Act. Questions related to privacy protection can be directed to the District's Privacy Officer at: 770 Vernon Ave, Victoria BC V8X 2W7, t.250-475-1775, [e.foi@saanich.ca](mailto:e.foi@saanich.ca)

## Obligations of the Artist

The obligations of the artist/artist team chosen through the competition process include the following requirements as part of the contract:

- **Insurance:** The artist must carry a minimum commercial general liability insurance of \$2,000,000 for the duration of the contract period. The cost of obtaining insurance can be included in the estimated budget portion of the application. If applicable, the selected artist must provide us with a GST registration number.
- **WorkSafeBC Coverage:** The artist must register with WorkSafeBC and hold either WorkSafeBC coverage or Personal Option Protection. The cost of carrying such coverage can be included in the estimated budget portion of the application.
- **Single/Prime Contractor:** The artist must be prepared to act as single/prime contractor during the installation of the artwork and ensure contracting and completion of the installation is done by approved contractors.
- **Artist Agreement:** Once approved, the artist must sign a contract with the District that outlines schedule, payment and other pertinent conditions.
- **Collaboration:** The Artists must be prepared to work collaboratively with District staff, project and design team members, and construction contractors to develop and finalize their proposals and designs and prepare and install their artwork to ensure a successful public art installation that meets requirements.
- **Maintenance Plan:** The artist must submit a detailed maintenance plan as part of their Artist Agreement with the District.
- **Copyright:** The artist retains copyright of the work but must be prepared to grant a license to the District to copy, publish, and use images and videos of the artwork and project for District-related purposes.



# Schedule One: Site Maps and Renderings of Potential Locations

## Figure 1: Fire Station No. 2 Redevelopment Project Site Plan



## Figure 2: Potential Artwork Locations

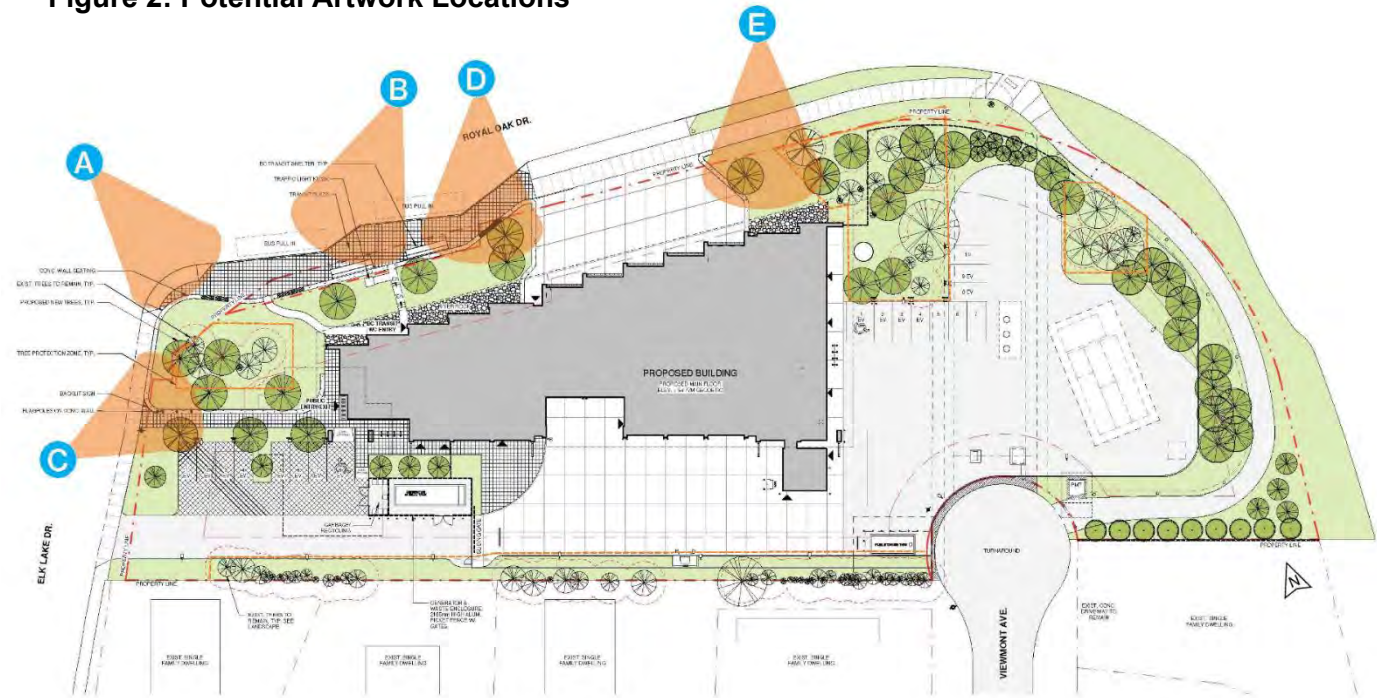

**Site Plan Note:** Existing trees depicted in non-fill (i.e. 4 oaks in NW corner); new plantings depicted in green. Some flexibility in new planting placements but overall tree numbers cannot be decreased).

**A** NW Corner



**Figure 3: Location “A” NW Corner to Transit Plaza (Rendering with potential 20-30 years tree growth.)**

**B** Transit Plaza



**Figure 4: Location “B” Transit Plaza to NW corner (Rendering with potential tree growth)**

**C** Pedestrian Entrance



**Figure 5: Location “C” Front Pedestrian Entrance (Rendering with potential tree growth in 20-30 years)**

**D** Royal Oak Dr. - Northwest Elevation



**Figure 6: Location “D” Fin Walls on Royal Oak Drive – NW Elevation with apparatus bays and transit shelters in view (Rendering with future tree growth)**

**E** Royal Oak Dr. - Northwest Elevation



**Fig. 7: Location “E” Fin Walls on Royal Oak Drive – NE Elevation with apparatus bays (Rendering with future tree growth)**